



WOODWARD-GRANGER COMMUNITY SCHOOL DISTRICT

Request for Competitive Quotes : 2024 Door Access Projects

Woodward-Granger Community School District
1904 State Street
Granger, IA 50109

Woodward-Granger Community School District is seeking vendors to partner with the district on **4 door access projects** to bring integration with our existing camera system Avigilon Alta Aware. The district is looking to implement Avigilon Alta Access Control or equivalent to achieve this integration.

The 4 separate projects are as follows:

Woodward-Granger Early Learning Center
2200 State Street
Granger IA 50109

Woodward-Granger Elementary
2002 Oak Street
Granger IA 50109

Woodward-Granger Middle School
306 West Third Street
Woodward IA 50276

Woodward-Granger High School
306 West Third Street
Woodward IA 50276

Walk-Through Opportunity:

Tuesday, July 16, 2024 10 am - 12 pm

Quotes Due Friday, July 26, 2024 at 1 PM CST:

Email quotes to : Cody Churchill codychurchill@wghawks.school

Cc quotes to : mattcrooks@wghawks.school, and marklane@wghawks.school

Mailed or drop off quotes arriving by 1 PM, July 26, 2024 will also be accepted.

Woodward-Granger Administration Office
2024 Door Access Projects
1904 State Street
Granger IA 50109

Projects are to be quoted separately

Early Learning Center Door Project

Existing Door Access Upgrades

- ELC Main Door Exterior - Camera Add
- ELC Main Door Interior
- ELC Front Office
- ELC West Door Hawks Nest
- ELC Dock Door
- ELC Playground
- ELC East Door

New Door Access Additions

- ELC Northwest Door
- ELC Southwest Door
- ELC Cafeteria East

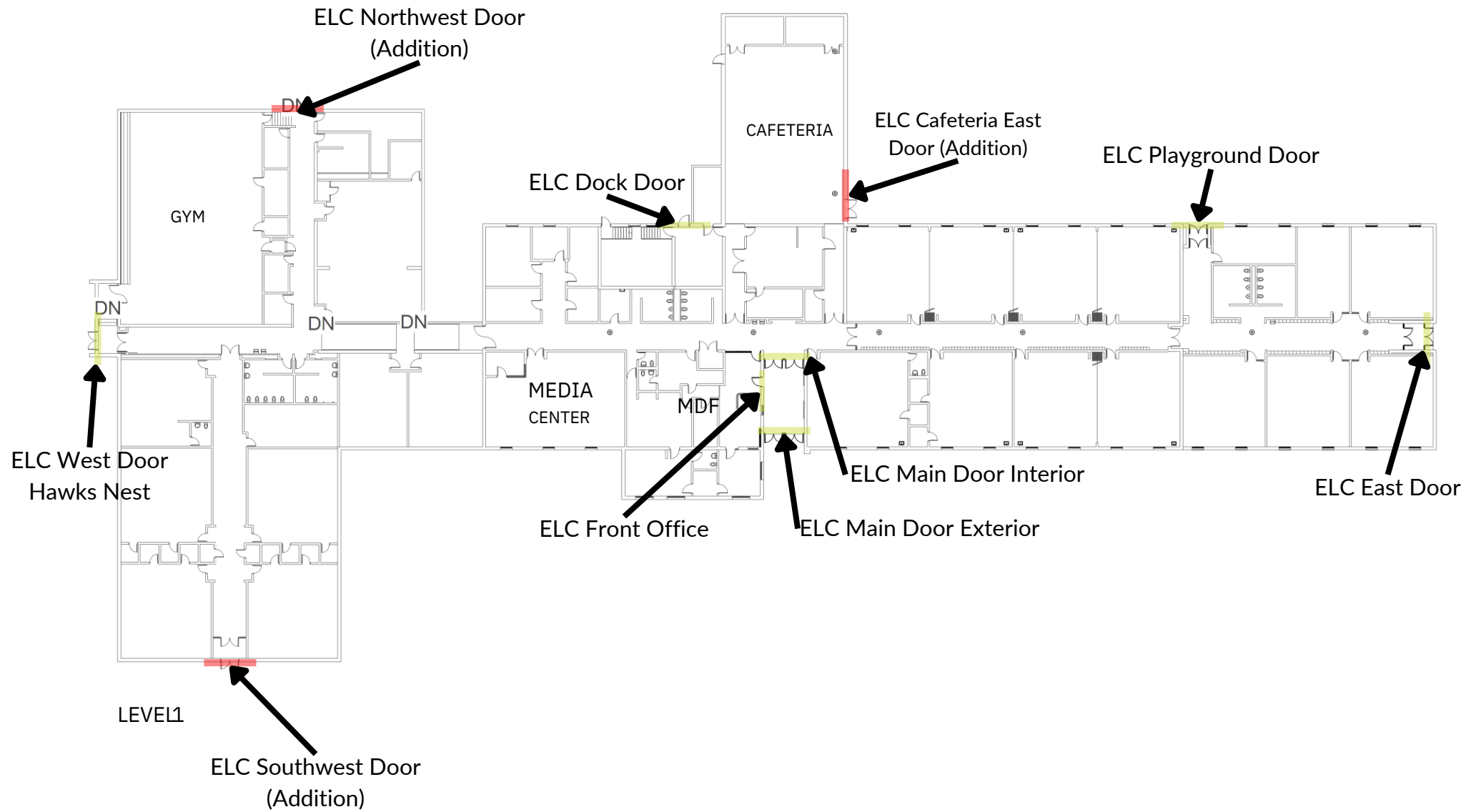

Unique Identifier: 00008030DC898AF6 Configuration Protected: No

Slot	Blade Type	Resource Details	Associated Portal	
1	Access Blade	reader 1: ELC Main Door Exterior Reader, Facility Code Mode: None	ELC Main Door Exterior	
		reader 2: ELC Main Door Interior Reader, Facility Code Mode: None	ELC Main Door Interior	
		input 1: ELC Main Door Exterior Contact	ELC Main Door Exterior	
		input 2: ELC Main Door Exterior Rex	ELC Main Door Exterior	
		input 3: ELC Main Door Interior Contact	ELC Main Door Interior	
		input 4: ELC Main Door Interior Rex	ELC Main Door Interior	
		output 1: ELC Main Door Exterior Strike	ELC Main Door Exterior	
		output 2: ELC ADA Exterior		
		output 3: ELC Main Door Interior Strike	ELC Main Door Interior	
		output 4: ELC ADA Interior		
		Serial Number: 3659		
		Module Revision: 27		

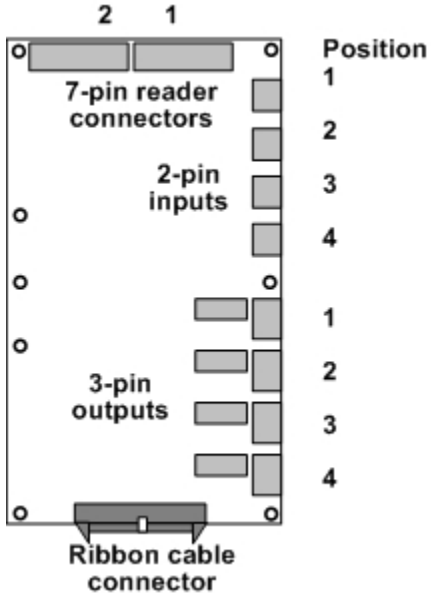

2	Access Blade	reader 1: ELC Front Office Reader, Facility Code Mode: None	ELC Front Office	
		reader 2: ELC West Door Reader, Facility Code Mode: None	ELC West Door Hawks Nest	
		input 1: ELC Front Office Contact	ELC Front Office	
		input 2: ELC Front Office Rex	ELC Front Office	
		input 3: ELC West Door Contact	ELC West Door Hawks Nest	
		input 4: ELC West Door Rex	ELC West Door Hawks Nest	
		output 1: ELC Front Office Strike	ELC Front Office	
		output 2:		
		output 3: ELC West Door Strike	ELC West Door Hawks Nest	
		output 4:		
		Serial Number: 2170		
		Module Revision: 27		

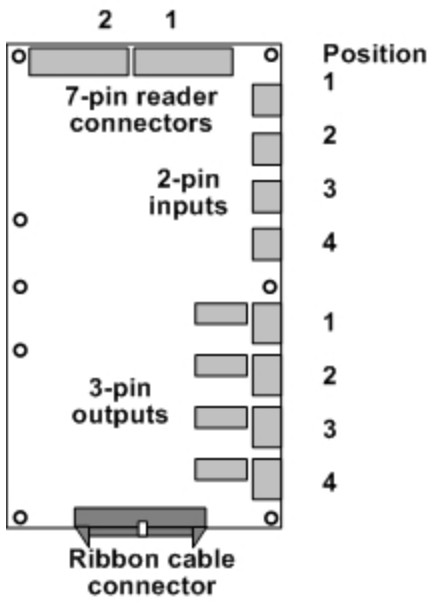

3 Access Blade

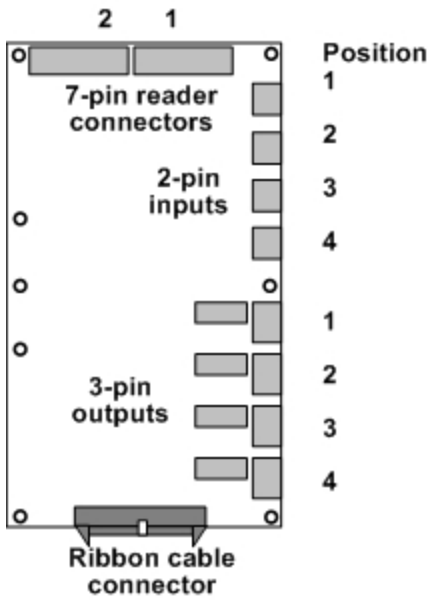

Serial Number: 2821
Module Revision: 27

reader 1: ELC Dock Door Reader, Facility Code Mode: None	ELC Dock Door
reader 2: ELC Playground Door Reader, Facility Code Mode: None	ELC Playground
input 1: ELC Dock Door Contact	ELC Dock Door
input 2: ELC Dock Door Rex	ELC Dock Door
input 3: ELC Playground Door Contact	ELC Playground
input 4: ELC Playground Door Rex	ELC Playground
output 1: ELC Dock Door Strike	ELC Dock Door
output 2:	
output 3: ELC Playground Door Strike	ELC Playground
output 4:	

4 Access Blade

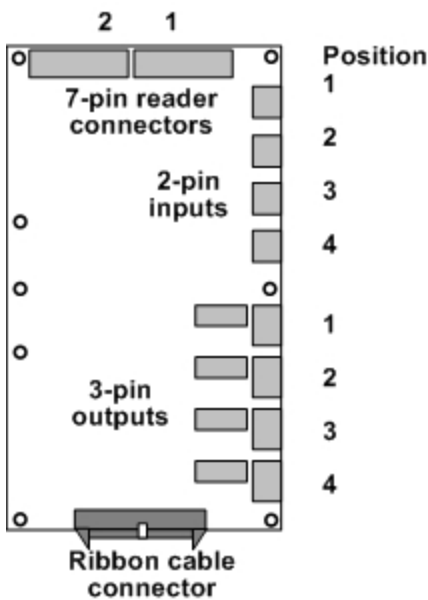

Serial Number: 5656
Module Revision: 30

reader 1: ELC East Door, Facility Code Mode: None	ELC East Door
reader 2:	
input 1: ELC East Door RTE	ELC East Door
input 2:	
input 3:	
input 4:	
output 1: ELC East Door Strike	ELC East Door
output 2:	
output 3:	
output 4:	

5 --

6 --

7 Input Blade

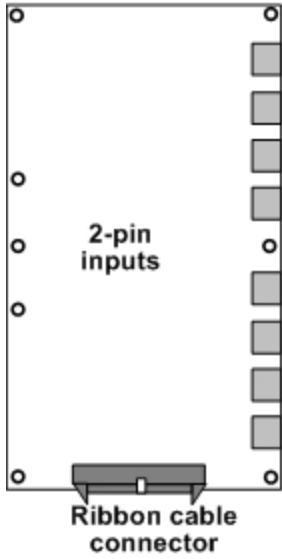

Position

1

2

3

4

5

6

7

8

input 1: ELC East Door DPS

ELC East Door

input 2: ELC ADA Ext Input

input 3: ELC ADA INT Input

input 4: ELC Office Door Release

input 5:

input 6:

input 7:

input 8:

Serial Number: 593

Module Revision: 27

Elementary Door Project

Existing Door Access Upgrades

- WGE Main Bank Exterior - Camera Add
- WGE Main Bank INT- Reader Add
- WGE Main Office
- WGE MDF
- WGE Vest B104
- WGE Hallway 142
- WGE 1st Floor North Fire Door
- WGE North Door B106
- WGE Hallway Gym
- WGE Vest B141
- WGE Receiving
- WGE South East Door
- WGE West Door

New Door Access Addition

- WGE 2nd Floor HVAC
- WGE Gym Equipment Door

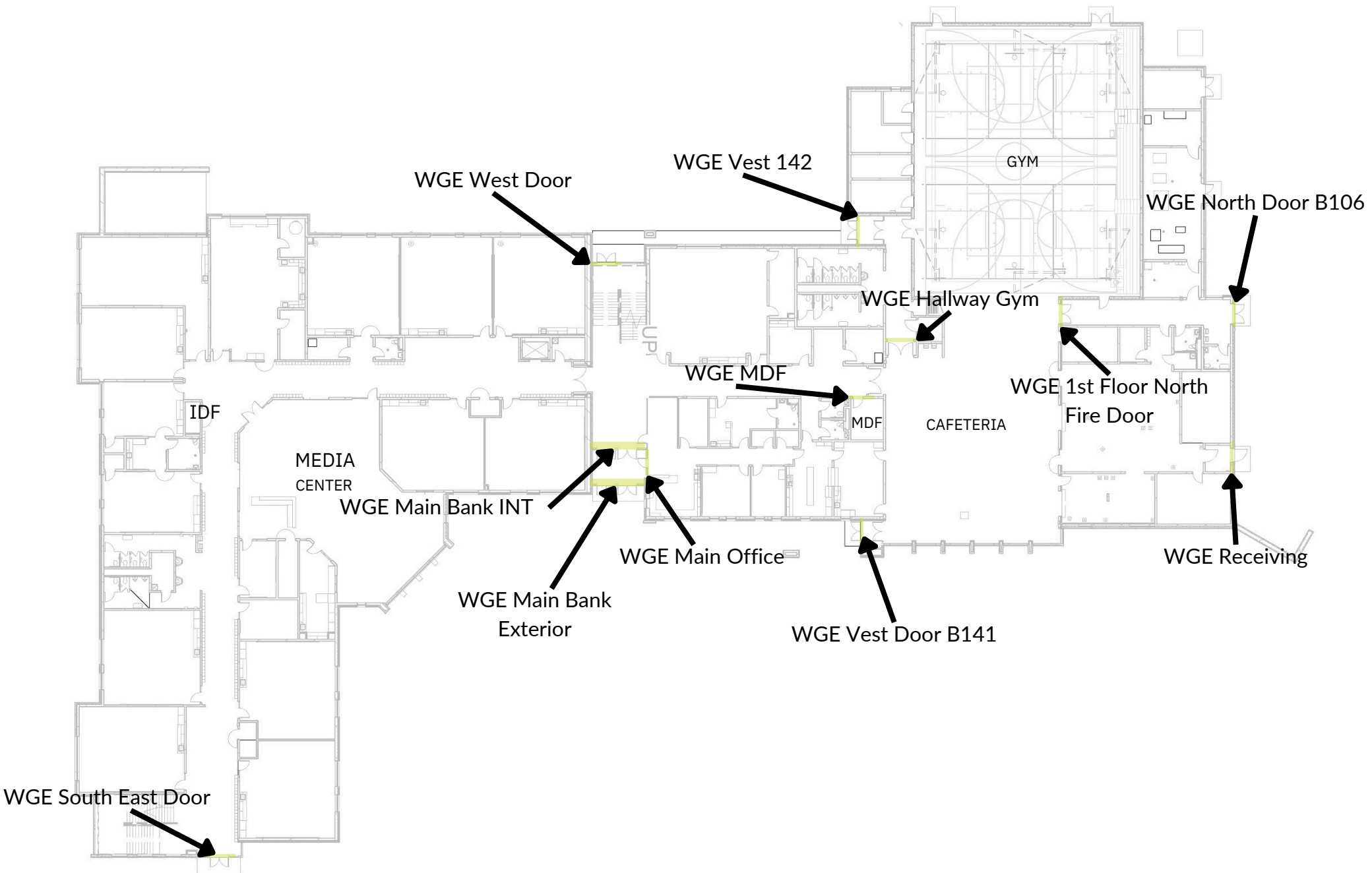

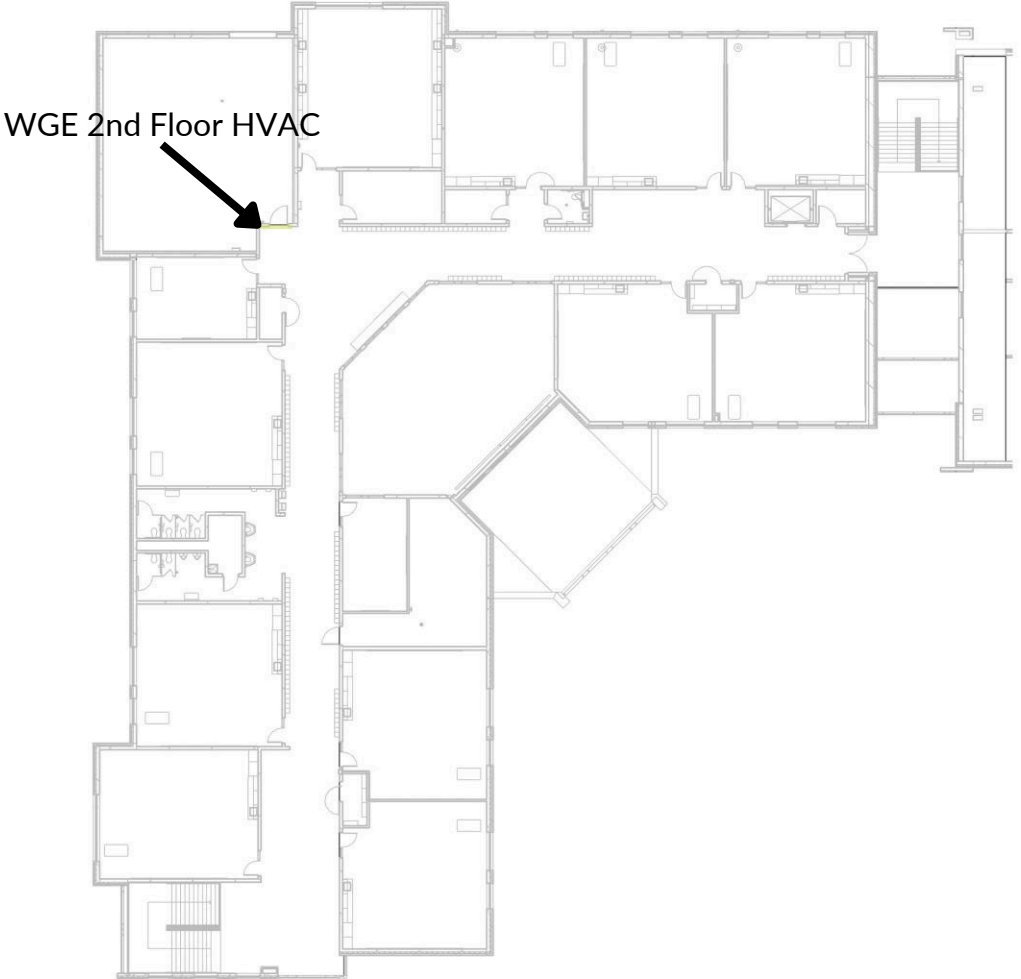

Unique Identifier: 0000587A627B33AF Configuration Protected: No

Slot	Blade Type	Resource Details	Associated Portal
1	Access Blade	reader 1: WGE Main Office Reader, Facility Code Mode: None	WGE Main Office
		reader 2: WGE MainBank INT not used, Facility Code Mode: None	
		input 1: WGE Main Office Contact	WGE Main Office
		input 2: WGE Main Office Rex	WGE Main Office
		input 3: WGE Main Bank INT Contact	WGE Main Bank INT
		input 4: WGE Main Bank INT Rex	WGE Main Bank INT
		output 1: WGE Main Office Lock	WGE Main Office
		output 2: WGE Main Bank INTADA	
		output 3: WGE Main Bank INT Lock	WGE Main Bank INT
		output 4: WGE Main Bank INTADA Exterior	

Serial Number: 3183

Module Revision: 27

Slot	Blade Type	Resource Details	Associated Portal
2	Access Blade	reader 1: WGE MDF Closet Reader, Facility Code Mode: None	WGE MDF
		reader 2: WGE Main Bank Ext. Reader, Facility Code Mode: None	WGE Main Bank Exterior
		input 1: WGE MDF Closet Contact	WGE MDF
		input 2: WGE MDF Closet Rex	WGE MDF
		input 3: WGE Main Bank Ext. Contact	WGE Main Bank Exterior
		input 4: WGE Main Bank Ext. Rex	WGE Main Bank Exterior
		output 1: WGE MDF Closet Lock	WGE MDF
		output 2: WGE Main Bank Ext. ADA	
		output 3: WGE Main Bank Ext. Lock	WGE Main Bank Exterior
		output 4: WGE Main Bank Ext. ADA Exterior	

Serial Number: 1486

Module Revision: 27

3 Access Blade

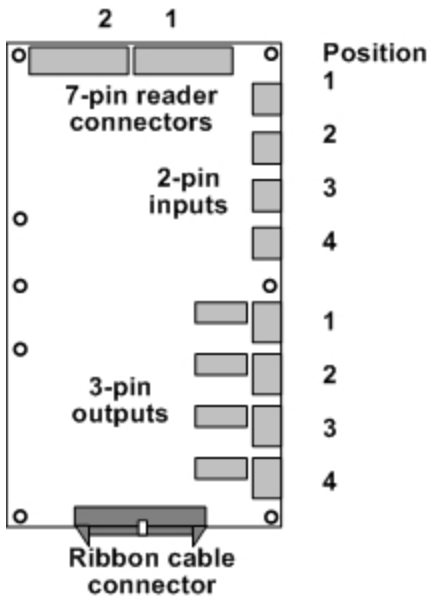

Serial Number: 65535

Module Revision: 27

reader 1: WGE Vest B104 Reader, Facility Code Mode: None	WGE Vest B104
reader 2: WGE Hallway B142 Reader, Facility Code Mode: None	WGE Hallway B142
input 1: WGE Vest B104 Contact	WGE Vest B104
input 2: WGE Vest B104 Rex	WGE Vest B104
input 3: WGE Hallway B142 Contact	WGE Hallway B142
input 4: WGE Hallway B142 Rex	WGE Hallway B142
output 1: WGE Vest B104 Lock	WGE Vest B104
output 2:	
output 3: WGE Hallway B142 Lock	WGE Hallway B142
output 4: WGE 1st Flr North Fire Door	WGE 1st Floor North Fire Door

4 Access Blade

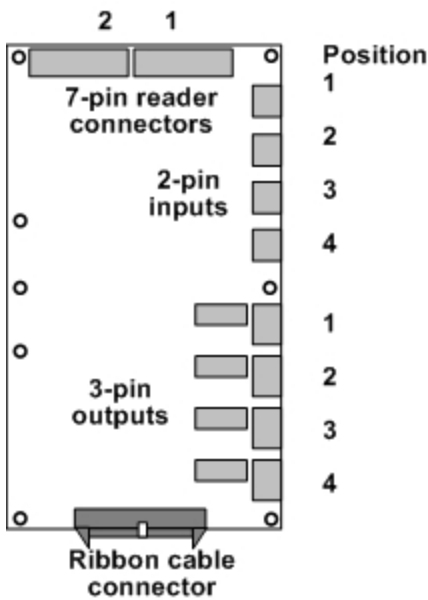

Serial Number: 65535

Module Revision: 27

reader 1: WGE Hallway Gym Reader, Facility Code Mode: None	WGE Hallway Gym
reader 2: WGE North Door B106 Reader, Facility Code Mode: None	WGE North Door B106
input 1: WGE Hallway Gym Contact	WGE Hallway Gym
input 2: WGE Hallway Gym Rex	WGE Hallway Gym
input 3: WGE North Door B106 Contact	WGE North Door B106
input 4: WGE North Door B106 Rex	WGE North Door B106
output 1: WGE Hallway Gym Lock	WGE Hallway Gym
output 2:	
output 3: WGE North Door B106 Lock	WGE North Door B106
output 4:	

5 Access Blade

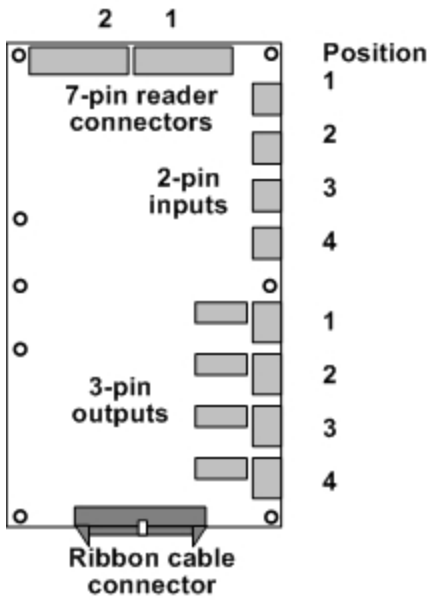

Serial Number: 2467

Module Revision: 27

reader 1: WGE Vest Dr B141 Reader, Facility Code Mode: None	WGE Vest Door B141
reader 2: WGE Receiving Reader, Facility Code Mode: None	WGE Receiving
input 1: WGE Vest Dr B141 Contact	WGE Vest Door B141
input 2: WGE Vest Dr B141 Rex	WGE Vest Door B141
input 3: WGE Receiving Contact	WGE Receiving
input 4: WGE Receiving Rex	WGE Receiving
output 1: WGE Vest Dr B141 Lock	WGE Vest Door B141
output 2:	
output 3: WGE Receiving Lock	WGE Receiving
output 4:	

6 Input Blade

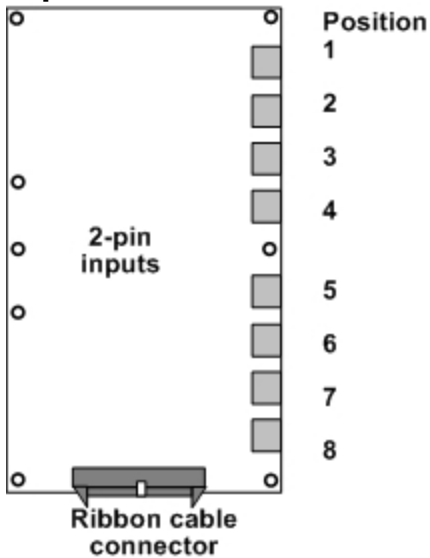

Serial Number: 41

Module Revision: 27

input 1: WGE North Fire Door 1st Floor	WGE 1st Floor North Fire Door
input 2:	
input 3:	
input 4:	
input 5:	
input 6:	
input 7:	
input 8:	

7 Input Blade

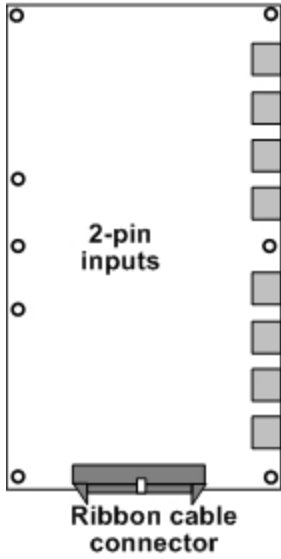

Position

1

input 1: WGE Main Bank IntADA

2

input 2: WGE Main EXT Bank ADA

3

input 3: WGE Lock Down Button

4

input 4: WGE Office Door Release Button

5

input 5: WGE South Gym Ext.

6

input 6: WGE North Gym Ext.

7

input 7: WGE North Exterior Storage Room

8

input 8: WGE Mechanical Room

Serial Number: 109

Module Revision: 27

Unique Identifier: 05000000382E7A27 Configuration Protected: No

Slot	Blade Type	Resource Details	Associated Portal
1	Access Blade	reader 1: South East Door Reader, Facility Code Mode: None	WGE South East Door
		reader 2: West Door Reader, Facility Code Mode: None	WGE West Door
		input 1: South East Door Contact	WGE South East Door
		input 2: South East Door Rex	WGE South East Door
		input 3: West Door Contact	WGE West Door
		input 4: West Door Rex	WGE West Door
		output 1: South East Door Lock	WGE South East Door
		output 2: 1st and 2nd South Fire Doors	WGE South Floor Fire Doors
		output 3: West Door Lock	WGE West Door
		output 4:	

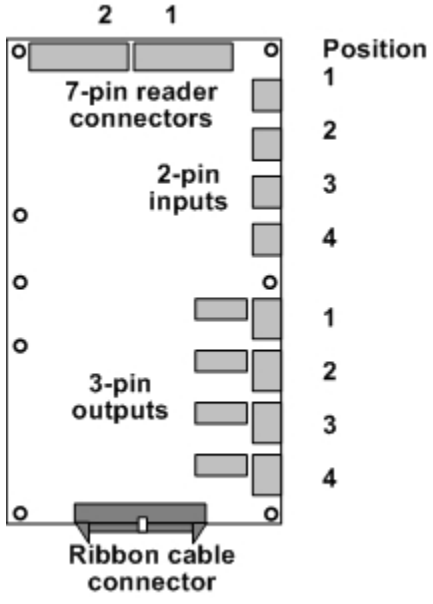

Serial Number: 2476
Module Revision: 27

- 2 --
- 3 --
- 4 --
- 5 --
- 6 --

Slot	Blade Type	Resource Details
7	Input Blade	input 1: WGE South Fire Door First Floor
		input 2: WGE South Fire Door 2nd Floor
		input 3:
		input 4:
		input 5:
		input 6:
		input 7:
		input 8:

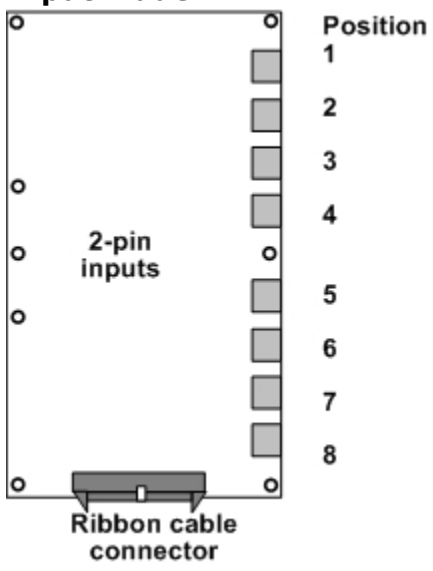

Middle School Door Project

Existing Door Access Upgrades

- MS S Ext Entry Door
- MS N Ext Entry Door
- MS S INT Entry Door
- MS Office Door - Camera Existing - Reader Add
- MS Gym Door - Wireless - move to Wired
- Janitor Closet Door - Wireless - move to Wired

New Door Access Addition

- MS Northeast Door
- MS West Bus Door
- MS Gym Equipment Door

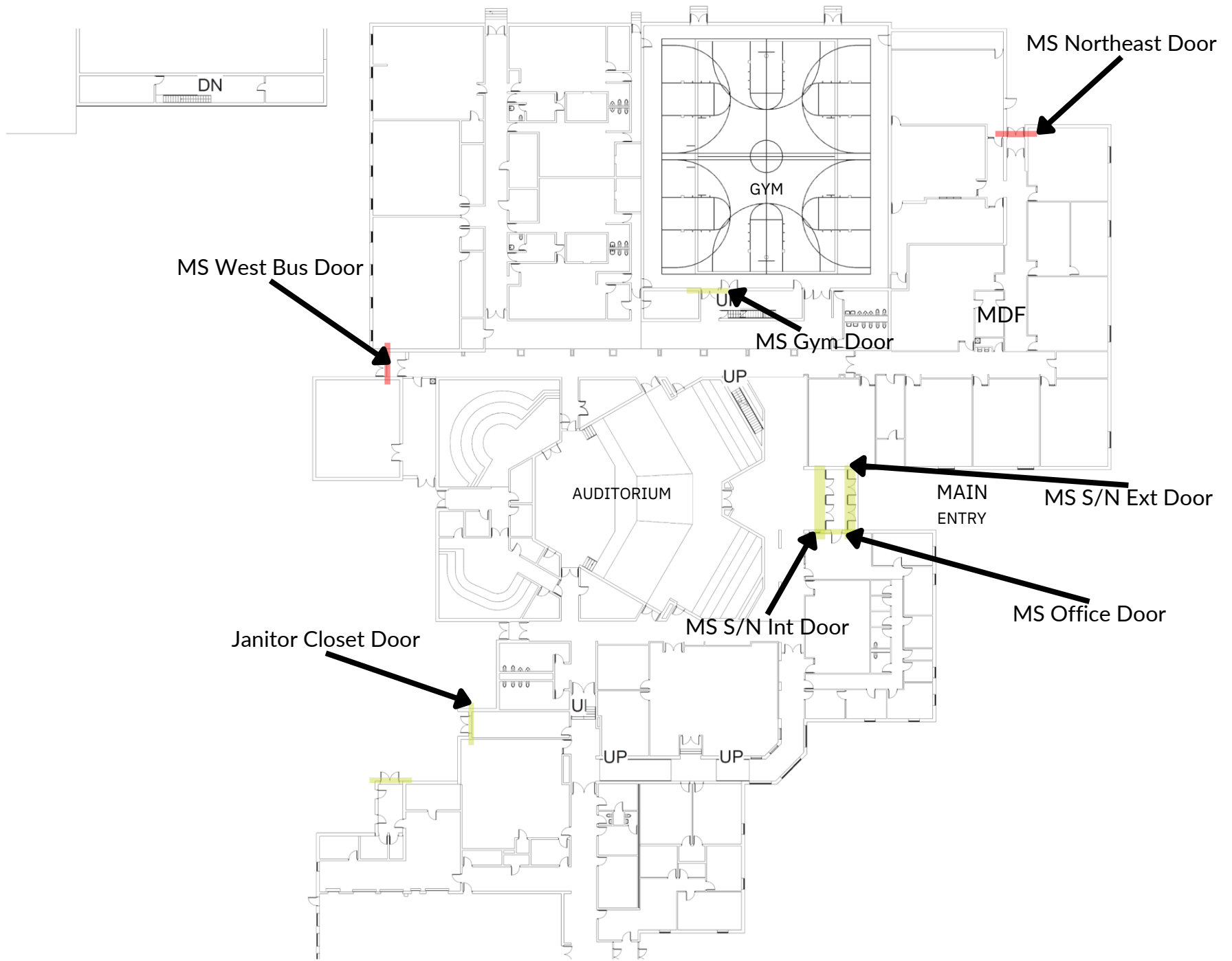

Unique Identifier: 0000C8FD19CEAA6C Configuration Protected: No

Slot Blade Type

Resource Details

Associated Portal

1 Access Blade

reader 1: MS Ext Entry S Door, Facility Code Mode: None

MS S Ext Entry Door

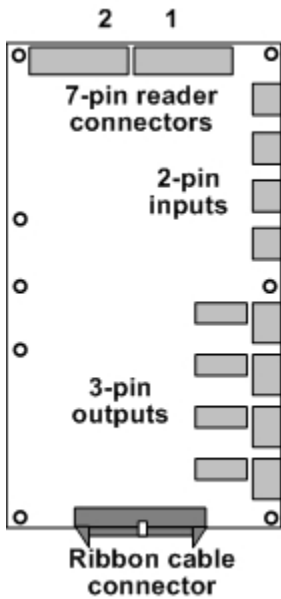

Position

1

2

3

4

1

2

3

4

reader 2: MS Int Entry S Door, Facility Code Mode: None

MS S INT Entry Door

input 1: MS Ext Entry S DPS

MS S Ext Entry Door

input 2: MS Ext Entry S Rex

MS S Ext Entry Door

input 3: MS Int Entry S DPS

MS S INT Entry Door

input 4: MS Int Entry S Rex

MS S INT Entry Door

output 1: MS Ext Entry S Output

MS S Ext Entry Door

output 2: MS ADA Ext Entry S Button

output 3: MS Int Entry S Output

MS S INT Entry Door

output 4: MS ADA Int Entry S Button

Serial Number: 649

Module Revision: 27

2 Access Blade

reader 1:

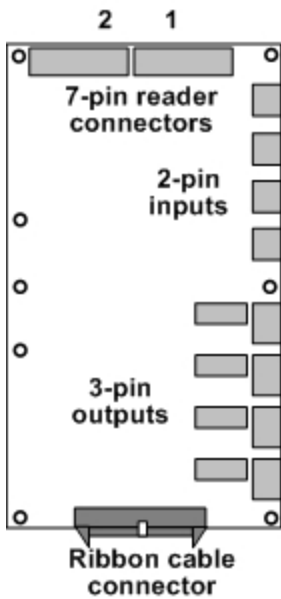

Position

1

2

3

4

1

2

3

4

reader 2:

input 1: MS INT Entry N Door DPS

MS N INT Entry door

input 2: MS INT Entry N Door REX

MS N INT Entry door

input 3: MS Int Entry N Door DPS

MS N EXT Entry Door

input 4: MS Int Entry N Door Rex

MS N EXT Entry Door

output 1: MS Ext N Strike

MS N INT Entry door

output 2:

output 3: MS Int N Strike

MS N EXT Entry Door

output 4:

Serial Number: 380

Module Revision: 27

3 Access Blade

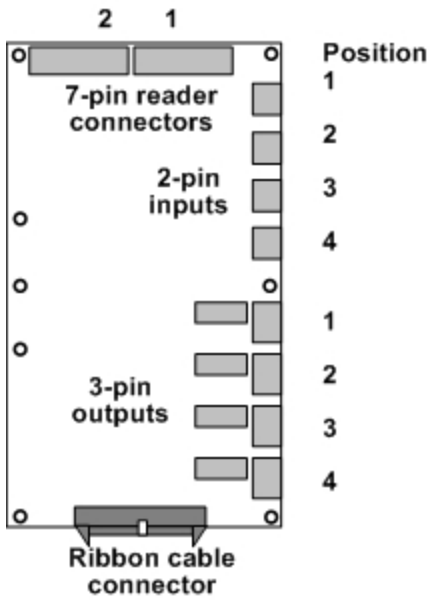

Serial Number: 6687
Module Revision: 27

reader 1:

reader 2:

input 1: Band Rm Exit Door DPS MS Band Rm Exit Door

input 2: Band Rm Exit Door Rex MS Band Rm Exit Door

input 3: MS Janitor Storage Dr DPS MS Janitor Storage Rm Door

input 4: MS Janitor Storage Dr Rex MS Janitor Storage Rm Door

output 1:

output 2:

output 3: Middel School I-Com Strike

output 4: Wooward Lockdown LED Red Active

4 Input Blade

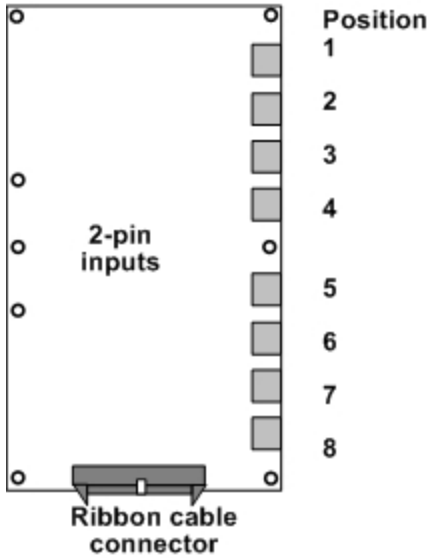

Serial Number: 123
Module Revision: 27

input 1: Woodward MS Lockdown Button

input 2: Middel School I-Com Trip

input 3:

input 4:

input 5:

input 6:

input 7:

input 8:

5 --

6 --

7 --

MS Gym PIM 105

IP Address: Subnet Mask: Gateway:

Unique Identifier: 1031079 Configuration Protected: No

Slot Blade Type

1 PIM400

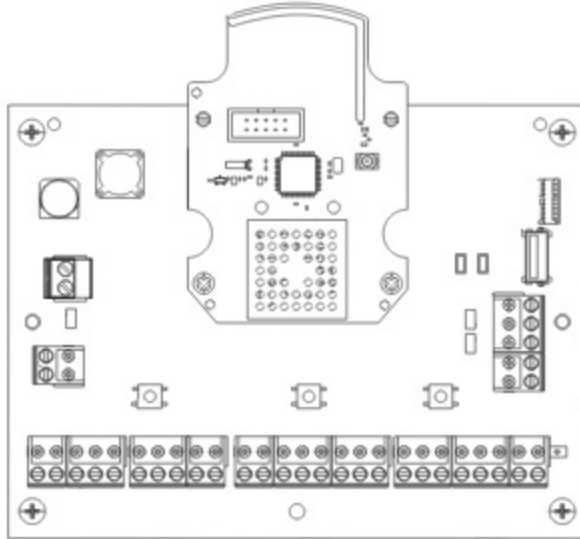

Serial Number: 0

Module Revision: 0

Resource Details

Associated Portal

input 1: MS Gym Dr DPS

MS Gym Door

input 2: MS Gym Dr Rex

MS Gym Door

input 3:

input 4:

input 5:

input 6:

input 7:

input 8:

input 9:

input 10:

2 --

3 --

4 --

5 --

6 --

7 --

8 --

9 --

10 --

11 --

12 --

13 --

14 --

15 --

16 --

17 --

High School Door Project

Existing Door Access Upgrades

- HS Entry INT Door
- HS Entry Ext Door
- HS Main Office - Camera Existing - Reader Add
- HS N Hall Entry - Add Camera
- HS Gym N Entry - Camer Existing
- HS Gym S Entry
- HS Gym Center Entry
- HS Gym Door - Wireless - move to Wired
- HS Kitchen Door - Wireless - move to Wired
- HS Weight Wrestling Rm

New Door Access Addition

- HS Southwest Door
- HS Gym Equipment Door

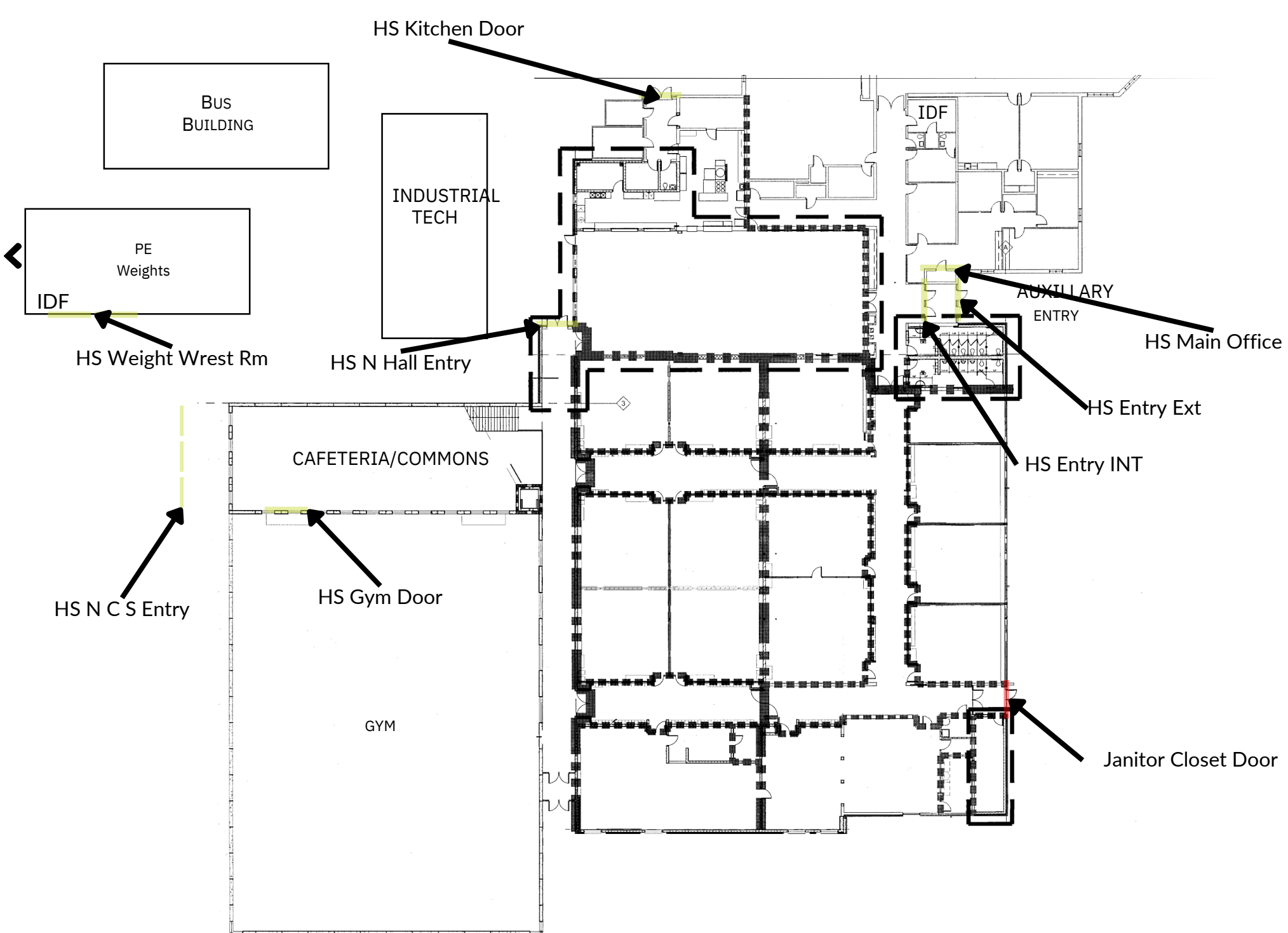

Woodward Granger HS IDF 101

Unique Identifier: 0000544A168E7973 Configuration Protected: No

Slot Blade Type

Resource Details

Associated Portal

1 Access Blade

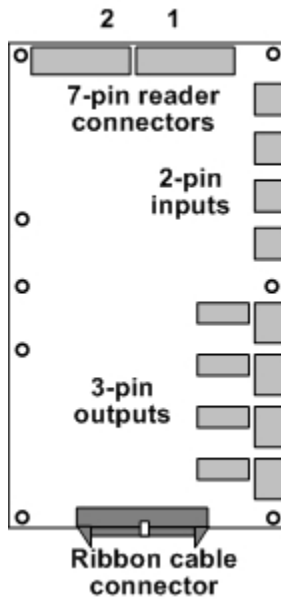

Position

reader 1: HS Int Entry Reader, Facility Code Mode: None

HS Entry INT Door

reader 2: HS Ext Entry Reader, Facility Code Mode: None

HS Entry Ext Door

input 1: HS Int Entry DC

HS Entry INT Door

input 2: HS Int Entry Rex

HS Entry INT Door

input 3: HS Ext Entry DC

HS Entry Ext Door

input 4: HS Ext Entry Rex

HS Entry Ext Door

output 1: HS Entry INT Push Bar

HS Entry INT Door

output 2: HS ADA INT Button Trip

HS Entry INT Door

output 3: HS Entry EXT Push Bar

HS Entry Ext Door

output 4: HS ADA EXT Button Trip

HS Entry Ext Door

Serial Number: 2956

Module Revision: 27

2 Access Blade

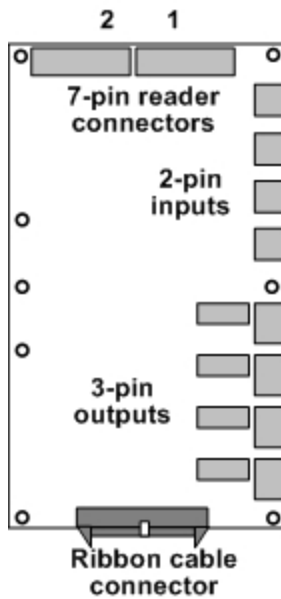

Position

reader 1: HS N Hall Entry Reader, Facility Code Mode: None

HS N Hall Entry Door

reader 2:

input 1: HS N Hall Entry DC

HS N Hall Entry Door

input 2: HS N Hall Entry Rex

HS N Hall Entry Door

input 3: HS S Hall Entry DC

input 4: HS S Hall Entry Rex

output 1: HS N Hall Entry Push Bars

HS N Hall Entry Door

output 2:

output 3:

output 4:

Serial Number: 270

Module Revision: 27

3 Access Blade

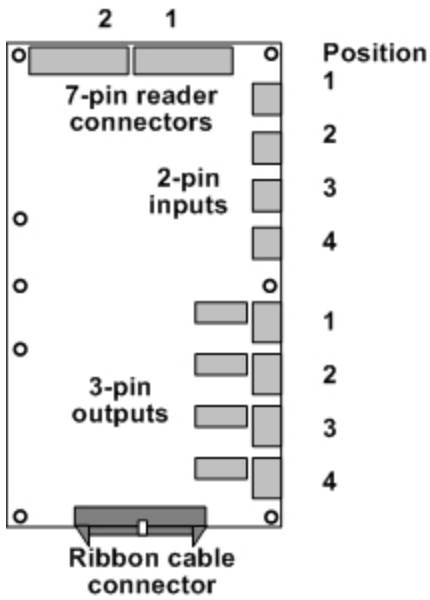

Serial Number: 316

Module Revision: 27

reader 1: HS N Gym Entry Reader, Facility Code Mode: HS Gym N Entry Door
None

reader 2:

input 1: HS N Gym Entry DC HS Gym N Entry Door

input 2: HS N Gym Entry Rex HS Gym N Entry Door

input 3: HS Center Gym Entry DC HS Gym Center Entry Door

input 4: HS Center Gym Entry Rex HS Gym Center Entry Door

output 1: HS N Gym Entry Push Bar HS Gym N Entry Door

output 2:

output 3: HS Center Gym Entry Push Bar HS Gym Center Entry Door

output 4:

4 Access Blade

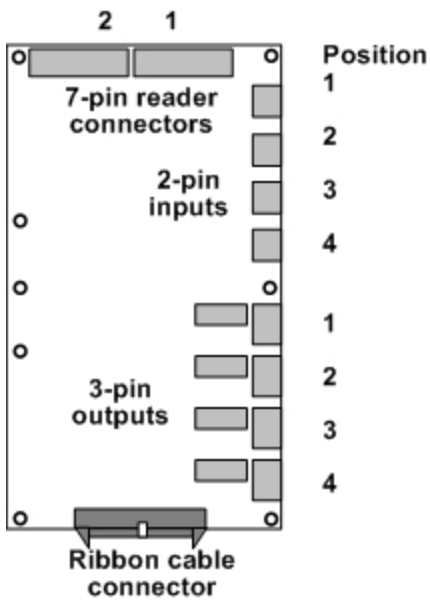

Serial Number: 315

Module Revision: 27

reader 1:

reader 2:

input 1: HS Gym S Entry Door DC HS Gym S Entry Doors

input 2: HS Gym S Door Rex HS Gym S Entry Doors

input 3:

input 4:

output 1: HS Gym S Entry Push Bars HS Gym S Entry Doors

output 2:

output 3: High School I-Com Strike

output 4:

5 Input Blade

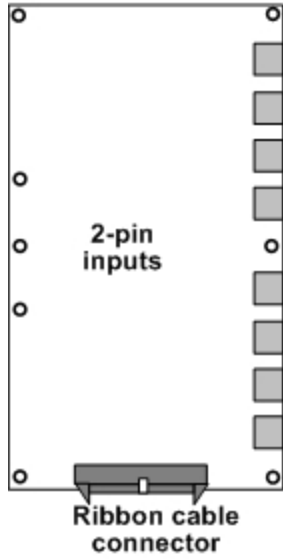

Position

1

input 1: Woodward HS lockdown Button

2

input 2: High School I-Com Trip

3

input 3: Intercom Trigger - HS Gym N Entry Door

4

input 4:

5

input 5:

6

input 6:

7

input 7:

8

input 8:

Serial Number: 151

Module Revision: 27

6 --

7 --

HS Gym PIM 103

IP Address:

Subnet Mask:

Gateway:

Unique Identifier: 1028210 Configuration Protected: No

Slot Blade Type

1 PIM400

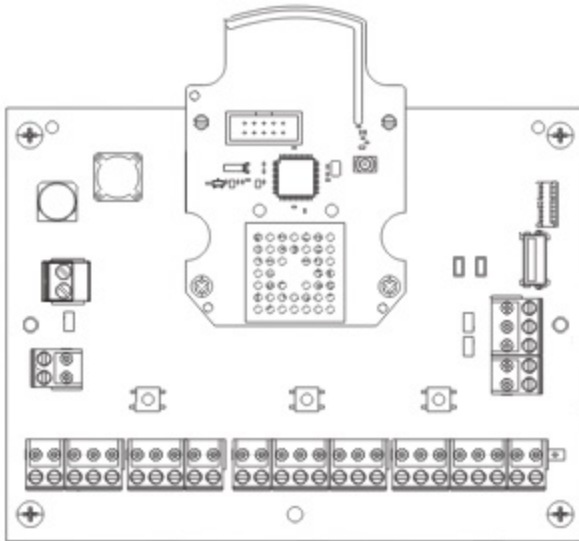

Serial Number: 982

Module Revision: 0

Resource Details

Associated Portal

input 1: HS Gym Dr DPS

HS Gym Door

input 2: HS Gym Dr Rex

HS Gym Door

input 3:

input 4:

input 5:

input 6:

input 7:

input 8:

input 9:

input 10:

2 --

3 --

4 --

5 --

6 --

7 --

8 --

9 --

10 --

11 --

12 --

13 --

14 --

15 --

16 --

17 --

18 --

HS Janitor Rec Kitchen PIM 104

IP Address: Subnet Mask: Gateway:

Unique Identifier: 1031078 Configuration Protected: No

Slot Blade Type

1 PIM400

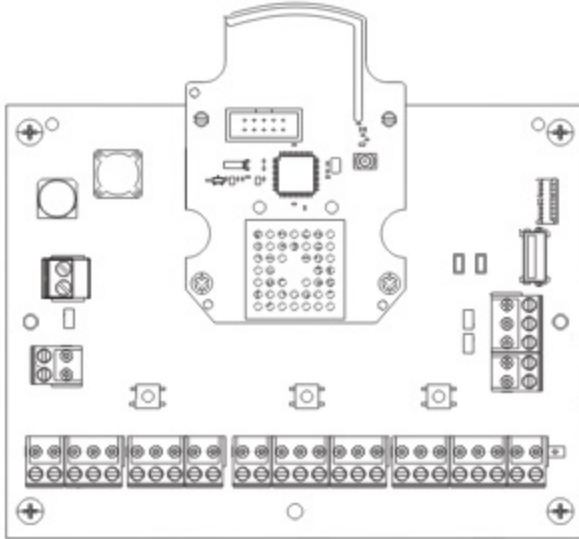

Serial Number: 2830

Module Revision: 0

Resource Details

Associated Portal

input 1: HS Kitchen Rec Dr DPS HS Kitchen Rec. Door

input 2: HS Kitchen Rec Dr Rex HS Kitchen Rec. Door

input 3: HS Janitor supply Dr DPS HS Janitor supply Door

input 4: HS Janitor Supply Dr Rex HS Janitor supply Door

input 5:

input 6:

input 7:

input 8:

input 9:

input 10:

2 --

3 --

4 --

5 --

6 --

7 --

8 --

9 --

10 --

11 --

12 --

13 --

14 --

15 --

16 --

17 --

Unique Identifier: 00009C1D583D1497 Configuration Protected: No

Slot Blade Type

Resource Details

Associated Portal

1 MicroNode Access Section

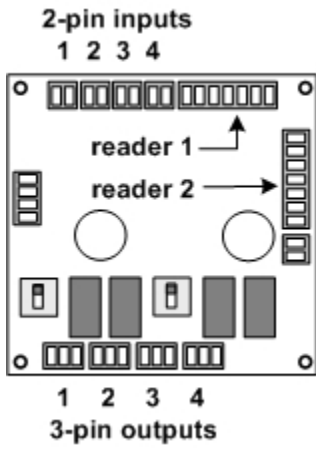

reader 1: HSMS Wrestling Rm Reader, Facility Code Mode: None

HSMS Wrestling Rm Door

reader 2:

input 1: HSMS Wrestling Rm Dr Contact

HSMS Wrestling Rm Door

input 2: HSMS Wrestling Rm Dr Rex

HSMS Wrestling Rm Door

input 3:

input 4:

output 1: HSMS Wrestling Rm Dr Stike

HSMS Wrestling Rm Door

output 2:

output 3:

output 4:

Serial Number: 2684

Module Revision: 27

2 MicroNode Temperature Section

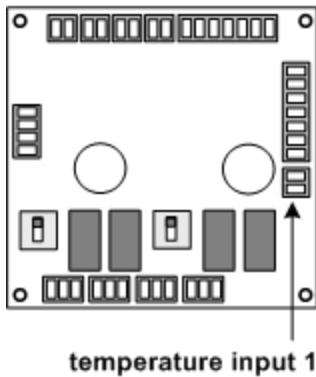

temp 1:

Serial Number: 2684

Module Revision: 27